

Old Bridge Square 1126 Route 9, Old Bridge, NJ
FOR LEASE 1,518 SF Former Restaurant



FOR PROPERTY INFORMATION, PLEASE CONTACT:

LEASING DEPARTMENT | 973.467.5000 | Retail@GardenHomes.com

GardenCommercial.com



This information has been obtained from sources believed reliable and is subject to errors, omissions, change of price, terms, prior sales and withdrawals. Any reliance solely on this information is at your own risk.

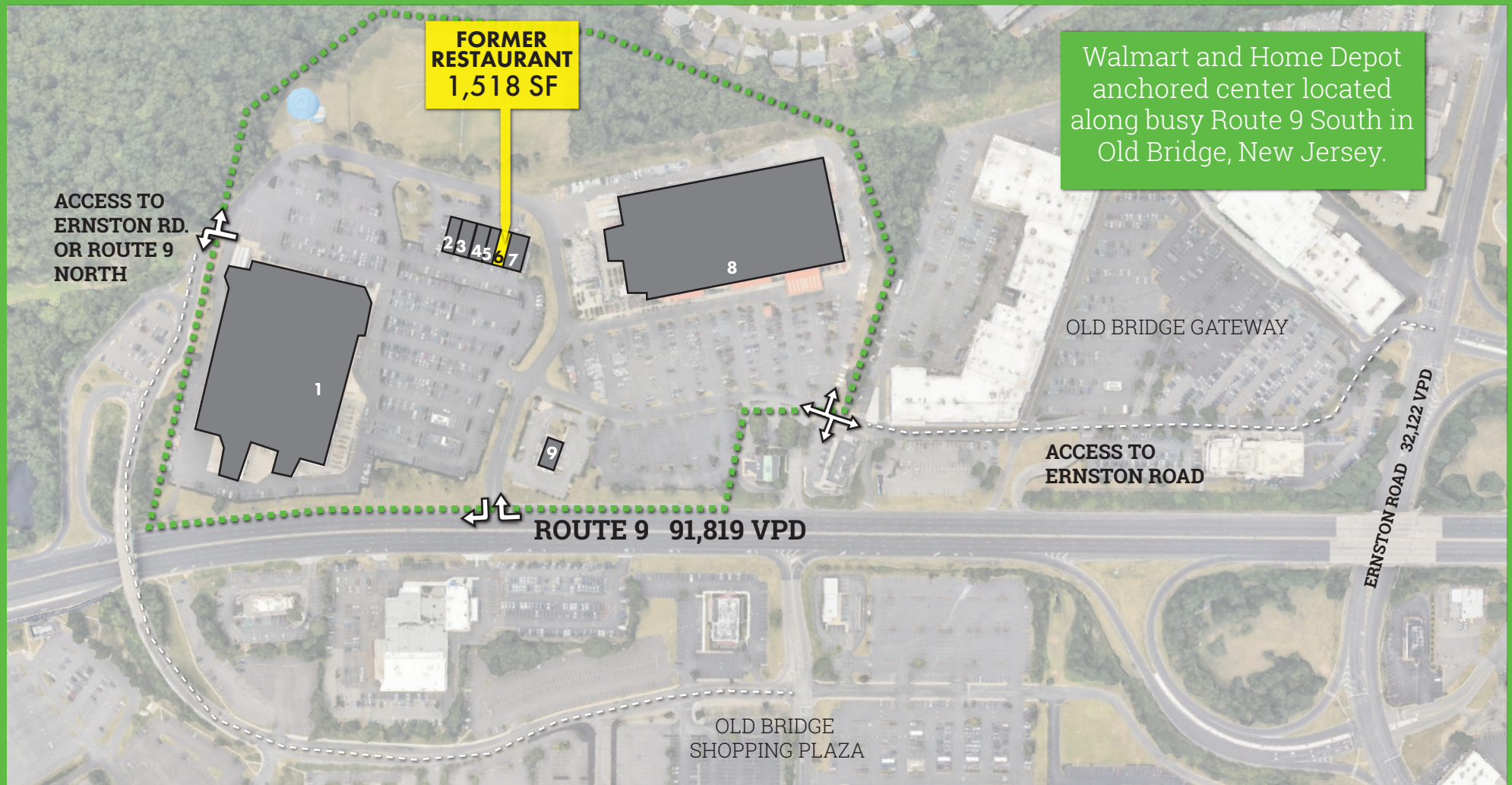

- | | | | |
|-------------|--------------|------------------------------|--------------------|
| 1. Walmart | 3. GameStop | 6. Subway | 7. AFC Urgent Care |
| 2. T-Mobile | 4. Five Guys | 7. AVAILABLE 1,518 SF | 8. Home Depot |
| | | | 9. KFC |

FOR PROPERTY INFORMATION, PLEASE CONTACT:

LEASING DEPARTMENT | 973.467.5000 | Retail@GardenHomes.com

GardenCommercial.com



This information has been obtained from sources believed reliable and is subject to errors, omissions, change of price, terms, prior sales and withdrawals. Any reliance solely on this information is at your own risk.



**FORMER
RESTAURANT
1,518 SF**

FOR PROPERTY INFORMATION, PLEASE CONTACT:

LEASING DEPARTMENT | 973.467.5000 | Retail@GardenHomes.com

GardenCommercial.com



This information has been obtained from sources believed reliable and is subject to errors, omissions, change of price, terms, prior sales and withdrawals. Any reliance solely on this information is at your own risk.

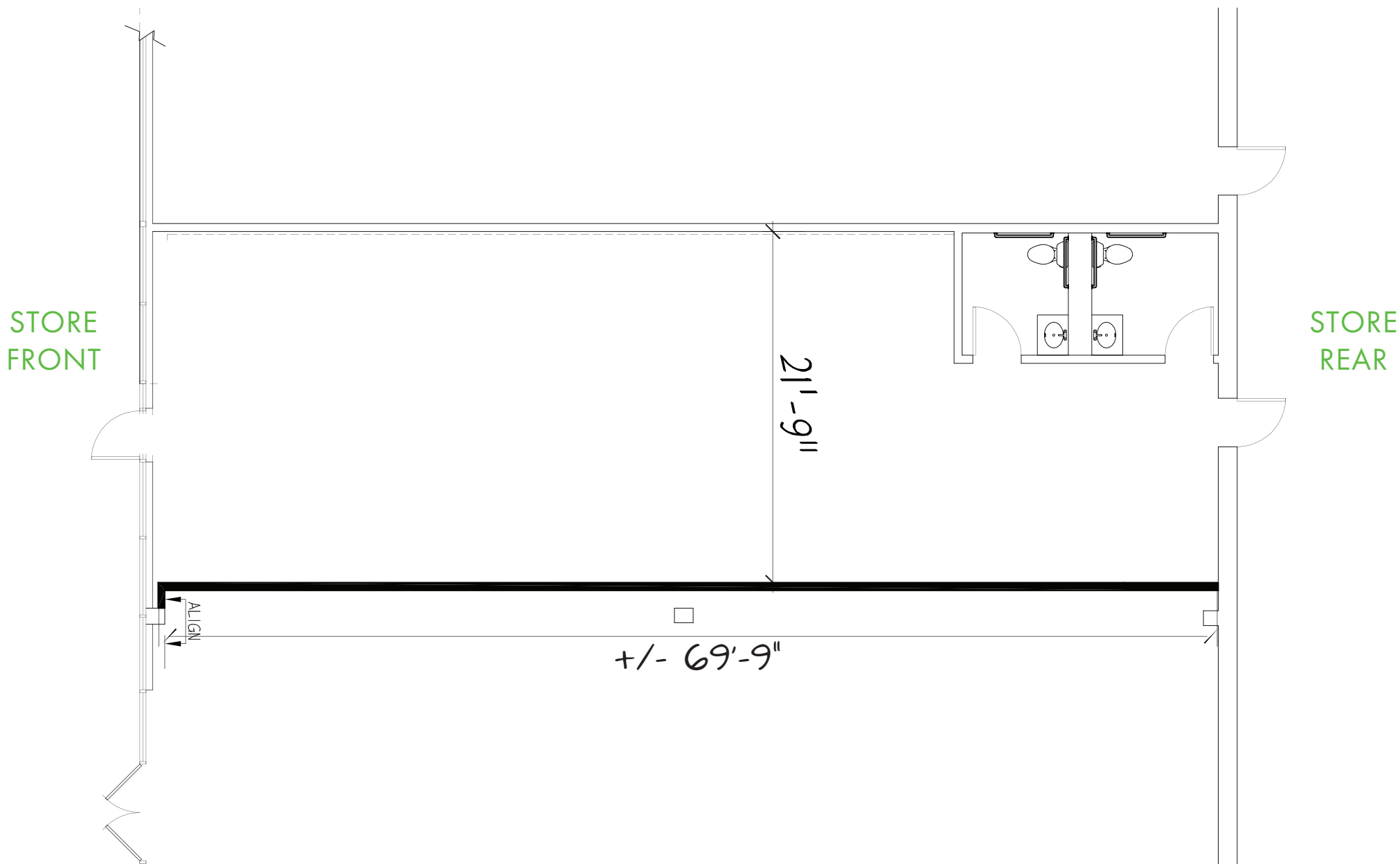

FOR PROPERTY INFORMATION, PLEASE CONTACT:

LEASING DEPARTMENT | 973.467.5000 | Retail@GardenHomes.com

GardenCommercial.com



This information has been obtained from sources believed reliable and is subject to errors, omissions, change of price, terms, prior sales and withdrawals. Any reliance solely on this information is at your own risk.

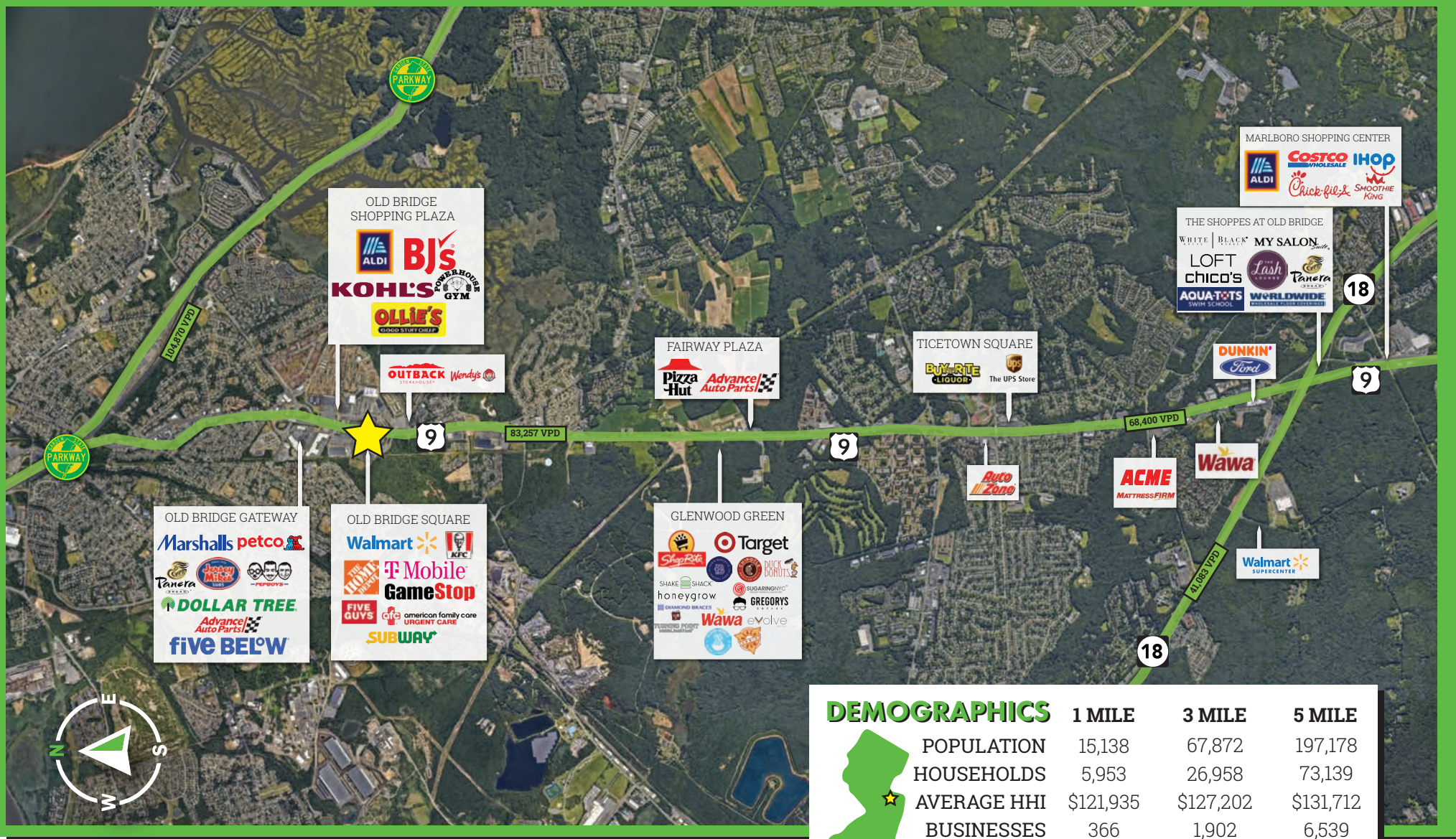

DEMOGRAPHICS	1 MILE	3 MILE	5 MILE
POPULATION	15,138	67,872	197,178
HOUSEHOLDS	5,953	26,958	73,139
AVERAGE HHI	\$121,935	\$127,202	\$131,712
BUSINESSES	366	1,902	6,539
EMPLOYEES	3,122	16,688	59,815
DAYTIME POP.	7,010	34,460	113,833

FOR PROPERTY INFORMATION, PLEASE CONTACT:

LEASING DEPARTMENT | 973.467.5000 | Retail@GardenHomes.com

GardenCommercial.com



This information has been obtained from sources believed reliable and is subject to errors, omissions, change of price, terms, prior sales and withdrawals. Any reliance solely on this information is at your own risk.